

**Water****Desalination****Chemicals****Electronics****Oil/Gas****Air/Gas****Inks/Paints/ Coatings****Power****Coolants****Pulp & Paper**

AQUALINE SERIES

Multi-Cartridge Filter Housings

- Economic multi-purpose cartridge filter housings available in ASME code and non-code industrial design housings.
- 150psig (10.3bar) @ 250°F(121.1°C) design pressure.
- Manufactured to accept multiple 10", 20", 30" and 40" cartridge filters.
- Vessels available in stainless steel 304 or 316.
- Available in swing bolt closures.
- Housings accept industry standard SOE and DOE filter cartridge configurations.

AQ SERIES

Cartridge Filter Housings
ASME Design/Industrial Design
Universal

Housing Specifications

Inlet/Outlet
1" to 6"

Inlet/Outlet Connection Types

Flange
Female Coupling
Male Coupling
Ferrules
Grooved Fittings (Victaulic)
BSP (British)

Dirty Drain

1/2" NPT – AQ08 to AQ10
1" NPT – AQ12 to AQ16

Clean Drain

1/2" NPT – AQ08 to AQ10
1" NPT – AQ12 to AQ16

Vent

1/2" NPT

Gauges

1/2" NPT

Certifications

U
UM
CRN

Aqualine Series

Fil-Trek's AQ series are ideal for use in industrial and commercial applications where flow rates vary between 20 and 1200 GPM. Each model is available in both stainless steel 304 and 316 and has a standard design pressure of 150psi (10 bar) @ 300°F.

Each model is standard with the following:

- A choice of v-band or swing bolt closures (v-band available for 8" non-code)
- External bead blast finish
- Buna-N gasket (other materials available)
- 2 gauge ports
- Universal bottom cups
- Fully welded construction throughout
- DOE filter cartridge configuration
- Legs (no legs on AQ08 and under, standard legs on AQ09/10 and heavy duty legs on AQ12 and above)
- Raised face weld neck flange for AQ08 to AQ14 and raised face slip on flange for AQ16

MODEL FLOW RATES

| MODEL | # OF FILTERS | MAX FLOW RATE | AVAILABLE INLET/OUTLET SIZES |
|----------|--------------|---------------|------------------------------|
| EAQ04* | 1 | 20 | 1" |
| AQ08-004 | 4 | 80 | 1" – 2.5" |
| AQ08-005 | 5 | 100 | 1" – 2.5" |
| AQ09 | 7 | 140 | 1" – 3" |
| AQ10 | 9 | 180 | 1" – 3" |
| AQ12 | 12 | 240 | 2" – 6" |
| AQ14 | 19 | 380 | 2" – 6" |
| AQ16 | 25 | 500 | 2" – 6" |

*EAQ04 only available in non-code. Flow rates based on water at 5 GPM/10" length (assuming 40" long cartridges). Actual flow rates are dependant on fluid viscosity, micron rating, contaminants and filter media.

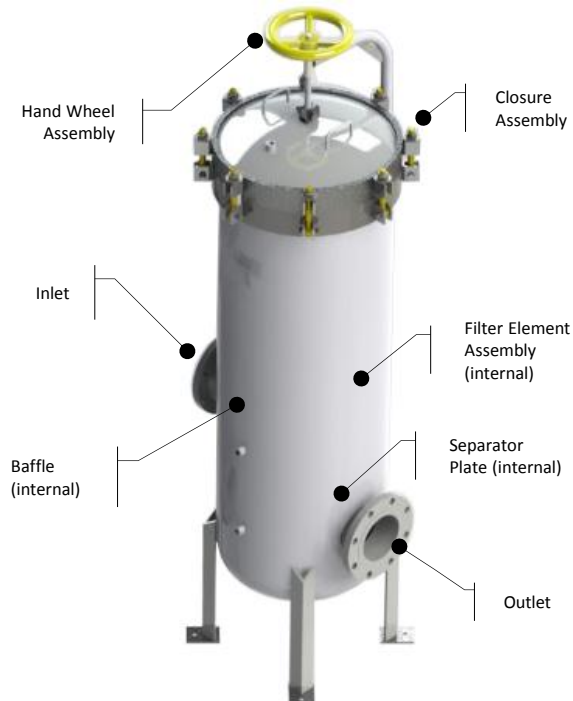

MATERIAL OF CONSTRUCTION

MAX. OPERATING PRESSURE (PSI @250°F)

MAX. DESIGN TEMP

304 STAINLESS STEEL

150 psi (10.3bar)

300°F (150°C)

316 STAINLESS STEEL

150 psi (10.3bar)

300°F (150°C)

MODEL DIMENSIONAL DETAILS

| MODEL | SHIPPING WEIGHT | A | B | C | D | E |
|--------------|-----------------|----------|----------|----------|-----------|--------------------|
| EAQ04-001-4* | 40 | 4 1/2" | 7" | 3" | 11" | 45 1/2" |
| AQ08-004-4 | 150 | 8" | 7" | 3" | 12" | 56 3/4"/50 1/8" |
| AQ08-005-4 | 150 | 8" | 7" | 3" | 12" | 56 3/4"/50 1/8" |
| AQ09-007-4 | 115 | 9" | 10 9/16" | 5 13/16" | 13" | 54 3/16"/51 3/4" |
| AQ10-009-4 | 115 | 10" | 10 9/16" | 5 13/16" | 14 1/2" | 54 1/8"/52 5/16" |
| AQ12-012-4 | 200 | 12" | 15 1/8" | 9 3/4" | 17 7/16" | 61 1/4"/59 13/16" |
| AQ14-019-4 | 255 | 14 5/16" | 15 7/8" | 10 1/8" | 19 13/16" | 60 7/16"/60 15/16" |
| AQ16-025-4 | 280 | 16 3/8" | 21 1/2" | 13 1/4" | 22 5/16" | 66 1/2"/64 11/16" |

*EAQ04 only available in non-code.

REFERENCE CHART LEGEND

| | |
|----------|------------------------|
| A | OUTSIDE DIAMETER |
| B | FLOOR TO INLET |
| C | FLOOR TO OUTLET |
| D | FACE TO FACE |
| E | OVERALL HEIGHT (SW/VB) |

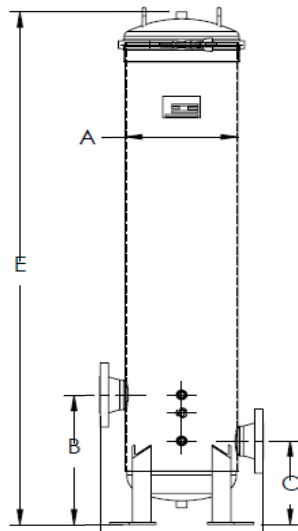
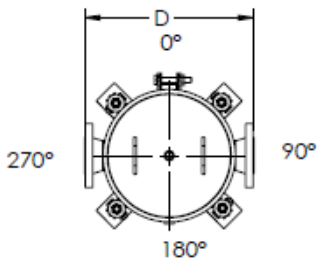

V-BAND CLOSURE
(8" ONLY)

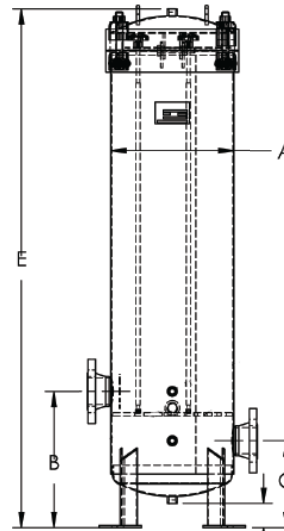

SWING BOLT CLOSURE

HOUSING OPTIONS

Finish Options

- (-) – Bead Blast (standard)
- EP1 – Electro polish Inside/Outside
- EP2 – Inside only
- EP3 – Outside only
- PP – Passivation

Leg Options

- (-) – No Legs (standard for AQ08)
- LT – Tabs
- LM – Legs (standard for AQ09 & AQ10)
- LA – Heavy Duty Legs (standard for AQ12 to AQ16)

O-Ring Options

- (-) – BN – Buna-N (standard)
- ED – EPDM
- VI – Viton
- SI – Silicone
- TEV – Teflon encapsulated Viton

Head Lift Options

- (-) – None (standard for AQ08 to AQ10)
- (-) – K2 – Hinge (standard w/ swing bolt closures for AQ12 to AQ16)

Filter Configuration

- (-) – E1 – Double Open End (standard)
- E2 – DOE w/ Gaskets
- E3 – DOE w/ Extended Core
- E4 – Single Open End w/ 222
- E5 – 222/Fin
- E8 – 222/Spring
- E9 – SOE w/ Spring

Accessories

- Direct Reading Gauge
- DP Gauge
- Safety Relief Valves
- Vent Valves
- Drain Valves
- Air Eliminator

Other Options

- Stainless Steel Bolting

PRODUCT NOMENCLATURE

| S4 | AQ | 09 | 007 | 4 | 2P | SW | - | - | - | - | - |
|-----------|----------------|------------------|--------------|---------------|-----------------|-----------------|----------------------------|------|---------|-----------|---------------|
| MATERIAL | MODEL | HOUSING DIAMETER | # OF FILTERS | FILTER LENGTH | CONNECTION TYPE | CLOSURE STYLE | FINISH | LEGS | O-RINGS | HEAD LIFT | FILTER CONFIG |
| S4 – 304L | AQ – ASME CODE | SEE TABLE | SEE TABLE | 1 – 10* | SEE TABLE | SW – SWING BOLT | SEE SIDE PANEL FOR OPTIONS | | | | |
| S6 – 316L | EAQ – NON-CODE | | | 2 – 20* | TABLE | VB – V-BAND** | | | | | |
| | | | | 3 – 30 | | | | | | | |
| | | | | 4 – 40 | | | | | | | |

*ONLY AVAILABLE FOR AQ04 TO AQ12

**V-BAND CLOSURES ONLY AVAILABLE FOR 8" EAQ (EAQ08).

NOTE: The AQ series in an ASME code stamped housing. This vessel is also available in a non-code design that is built to code but is not stamped.

For non-code, add the prefix "E" to the AQ in the part number.

AQ SERIES

Cartridge Filter Housings
ASME Design/Industrial Design
Universal

FLOW CHART

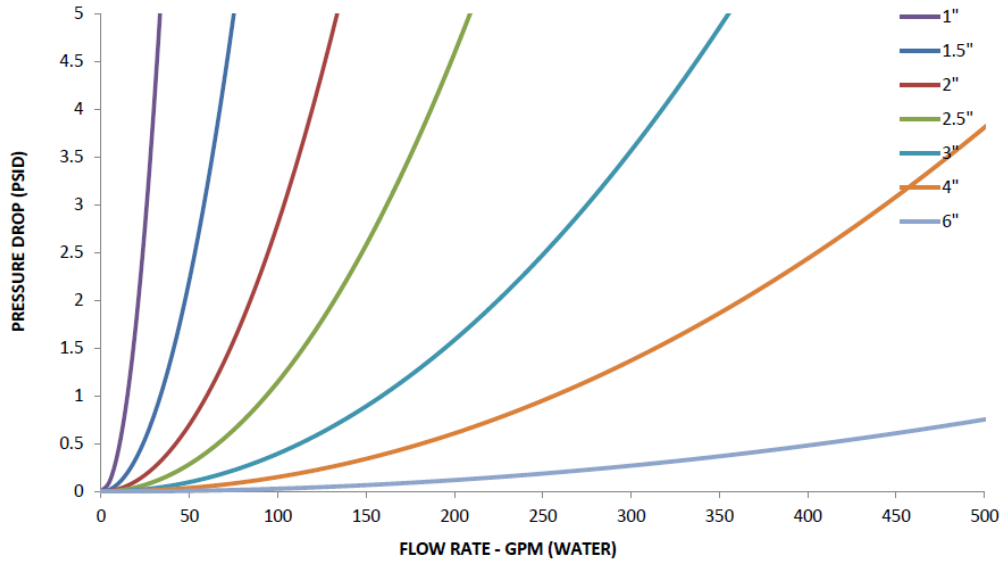

ISC Sales

ISCSales.com
ISCInfo@ISCSales.com

877-602-0010
972-964-2700

4421 Tradition Trail
Plano, TX 75093