



Water



Desalination



Chemicals



Electronics



Oil/Gas



Air/Gas



Inks/Paints/ Coatings



Power



Coolants



Pulp & Paper

GL SERIES

Multi-Cartridge Filter Housings

- Multi-purpose industrial ASME code ("U" & "UM") and non-code design housings.
- Accepts multiple 10", 20", 30" or 40" cartridges.
- 150psig (10.3bar) @ 400°F(204.4°C) design pressure.
- Vessels available in carbon or stainless steel 304 or 316.
- Also available in LDX2101, C276, AL6XN, 2205, 2507 & Monel 400.
- Housings accept industry standard double open end style cartridges.
- Models can be designed to accept single open end cartridges.
- Swing bolt closure allows for quick element change out

GL SERIES

Cartridge Filter Housing
ASME Design/Non-Code
Universal

HOUSINGS SPECIFICATIONS

Inlet/Outlet

Flange
NPT

Dirty Drain

1" NPT on GL16 and smaller
2" NPT on GL18 and larger

Clean Drain

1" NPT on GL16 and smaller
2" NPT on GL18 and larger

Vent

½" NPT on all sizes (std)

Gauges

½" NPT on all sizes (std)

Headlift

Mechanical Davit on GL12 and larger (std)
Hydraulic Davit on GL40 and larger (std)

Cover

Flat top cover on GL10 and smaller (std)

Legs

Angle Iron Legs with footpads (std)

Closure

Swing bolt closure (std)

Standard Pressure

150psi

Standard Temperature

400°F (204°C)

Certifications

U
UM
CE
NB
CRN

GL SERIES

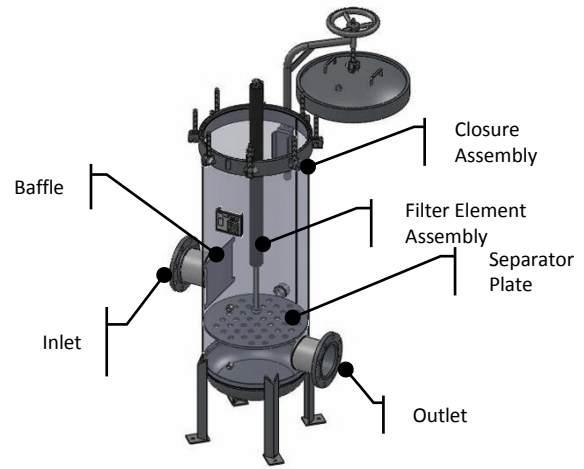

MODEL FLOW RATES

MODEL	# OF FILTERS 2.5"OD	FLOW RATE (GPM) 2.5" FILTERS	# OF FILTERS 2.75"OD	FLOW RATE (GPM) 2.75" FILTERS	MAX INLET/OUTLET
GL04	1	20	1	20	2"
GL06	3	60	2	40	2"
GL08	6	120	5	100	3"
GL10	10	200	8	160	3"
GL12	12	240	11	220	4"
GL13	15	300	12	240	4"
GL14	19	380	14	280	4"
GL16	25	500	20	400	6"
GL18	32	640	26	520	6"
GL20	40	800	32	640	6"
GL22	52	1040	40	800	8"
GL24	60	1200	52	1040	8"
GL26	68	1360	56	1120	8"
GL28	81	1620	66	1320	10"
GL30	93	1860	76	1520	10"
GL32	112	2240	86	1720	10"
GL34	122	2440	100	2000	12"
GL36	142	2840	110	2200	12"
GL38	150	3000	125	2500	14"
GL40	180	3600	135	2700	14"
GL42	194	3880	150	3000	14"
GL44	210	4200	175	3500	16"
GL46	230	4600	190	3800	16"
GL48	257	5140	210	4200	16"
GL50	280	5600	230	4600	18"
GL52	300	6000	250	5000	18"
GL54	330	6600	275	5500	18"
GL56	350	7000	290	5800	18"
GL58	375	7500	310	6200	20"
GL60	400	8000	335	6700	20"

Flow rates based on water at 5gpm/10" (assuming 40" cartridges). Actual Flow rate is dependent on fluid viscosity, cartridge micron rating, contaminant and type of media.

MATERIAL OF CONSTRUCTION

MATERIAL OF CONSTRUCTION	MAX. OPERATING PRESSURE (PSI @250°F)	MAX. DESIGN TEMP
CARBON STEEL	150 psi (10.3bar)	400°F (204°C)
304 STAINLESS STEEL	150 psi (10.3bar)	400°F (204°C)
316 STAINLESS STEEL	150 psi (10.3bar)	400°F (204°C)

MODEL DIMENSIONAL DETAILS

MODEL	SHIPPING WEIGHT (LBS)	A	B	C	D	E
GL04-001-4-2F	100	4 ½"	20"	14"	14"	62"
GL06-003-4-2F	125	6 5/8"	22"	16"	16"	64"
GL08-006-4-3F	200	8 5/8"	22"	16"	18"	65"
GL10-010-4-3F	240	10 ¾"	24"	18"	20"	68"
GL12-012-4-4F	280	12"	24"	18"	22"	72"
GL13-015-4-4F	320	13"	26"	18"	24"	76"
GL14-019-4-4F	360	14 ½"	28"	18"	26"	80"
GL16-025-4-6F	400	16 ½"	30"	18"	28"	82"
GL18-032-4-6F	550	18 ½"	32"	20"	30"	84"
GL20-040-4-6F	600	20 ½"	34"	20"	34"	86"
GL22-052-4-8F	650	22 ½"	36"	22"	36"	86"
GL24-060-4-8F	850	24 ½"	38"	24"	38"	90"
GL26-068-4-8F	950	26 ½"	40"	26"	40"	92"
GL28-081-4-10F	1050	28 ½"	42"	28"	44"	96"
GL30-093-4-10F	1200	30 ½"	42"	28"	46"	98"
GL32-112-4-10F	1400	32 ½"	44"	28"	48"	100"
GL34-122-4-12F	1500	34 ¾"	46"	30"	52"	106"
GL36-142-4-12F	1650	36 ¾"	46"	30"	54"	108"
GL38-150-4-14F	1800	38 ¾"	46"	32"	58"	110"
GL40-180-4-14F	2200	40 ¾"	48"	32"	60"	112"
GL42-194-4-14F	2300	42 ¾"	48"	36"	62"	114"
GL44-210-4-16F	2500	44 ¾"	50"	36"	66"	118"
GL46-230-4-16F	2650	47"	50"	36"	68"	120"
GL48-257-4-16F	2800	49"	52"	36"	70"	120"
GL50-280-4-18F	3000	51"	52"	40"	74"	124"
GL52-300-4-18F	3200	53"	54"	40"	76"	126"
GL54-330-4-18F	3450	55"	54"	40"	78"	128"
GL56-350-4-18F	3700	57"	54"	40"	80"	130"
GL58-375-4-20F	4000	59"	56"	44"	84"	132"
GL60-400-4-20F	4400	61"	56"	44"	86"	134"

NOTE: Above dimensions are for Style A.
For other options contact factory.

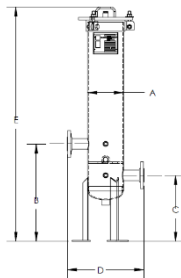

REFERENCE CHART LEGEND

A	OUTSIDE DIAMETER
B	FLOOR TO INLET
C	FLOOR TO OUTLET
D	FACE TO FACE
E	OVERALL HEIGHT

PRODUCT NOMENCLATURE

S6	GL	16	025	4	6F	150	-
MOC	MODEL	HOUSING DIAMETER	# OF FILTERS	LENGTH	CONNECTION TYPE	DESIGN PRESSURE	OPTIONS
(-) CS	GL ASME CODE	SEE TABLE	SEE TABLE	1 – 10	SEE TABLE	150	SEE SIDE PANEL FOR OPTIONS
S4	EGL			2 – 20			
SS304	NON ASME			3 – 30			
S6				4 – 40			
SS316							

NOTE: The GL series in an ASME code stamped housing. This vessel is also available in an industrial non-code design.

For non-code, add the prefix "E" to the GL in the part number.

HOUSING OPTIONS

Configuration Options

- (-) A – Side in/side out (std)
- B – In-Line
- C – Side in/Bottom out
- D – Side in/Side out, Same Side

Finish Options

- (-) – External paint "National Blue" (std for carbon steel housings)
- (-) – Bead Blast (std for stainless steel 304 and 316)
- EP1 – Electro polish Inside/Outside
- EP2 – Inside only
- EP3 – Outside only
- PP – Passivation

O-Ring Options

- (-) – BN – Buna-N (std)
- ED – EPDM
- VI – Viton
- SI – Silicone
- TEV – Teflon encapsulated Viton
- TF – Teflon

Filter Configuration

- (-) – E1 – Double Open End (std)
- E2 – DOE with Gasket Ends
- E3 – DOE with 1" Ext. Core
- E4 – SOE Flat End 222 Open End
- E5 – SOE Fin End 222 Open End
- E8 – SOE Plastic Spring Top 222
- E9 – SOE Plastic Spring Top

Accessories

- Direct Reading Gauge
- DP Gauge
- Safety Relief Valves
- Vent Valves
- Drain Valves
- Air Eliminator

GL SERIES

Cartridge Filter Housing
ASME Design/Non-Code
Universal

FLOW CHART

GL04 to GL10

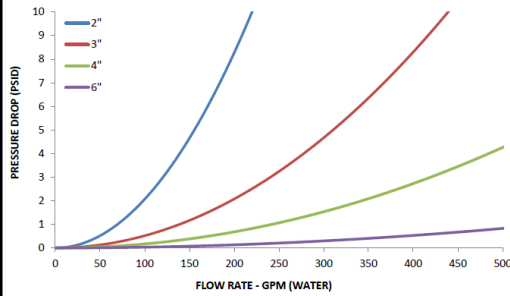

GL12 to GL16

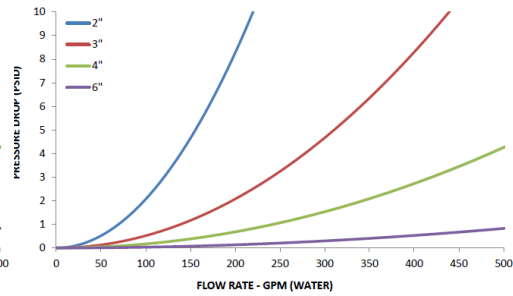

GL18 to GL40

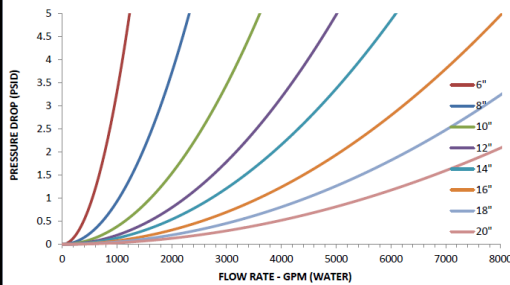

GL42 to GL60

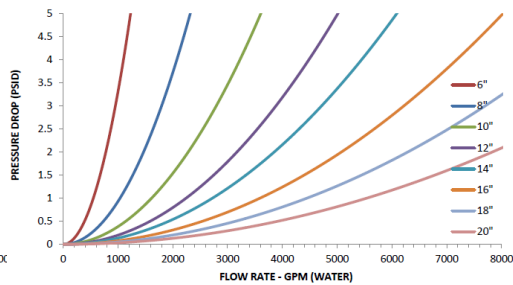

ADDITIONAL MODEL CONFIGURATIONS

STYLE B

Inline

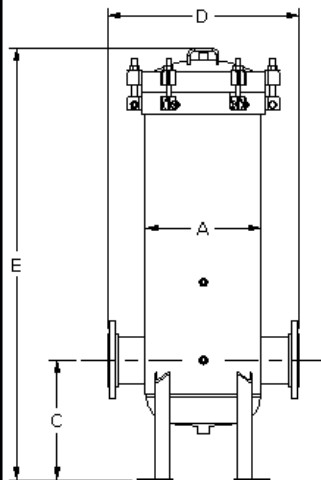

STYLE C

Side In/Bottom Out

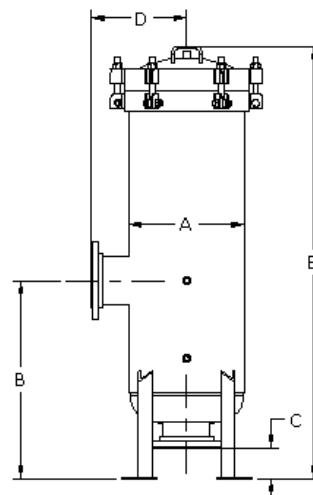

STYLE D

Side In /Side Out Same Side

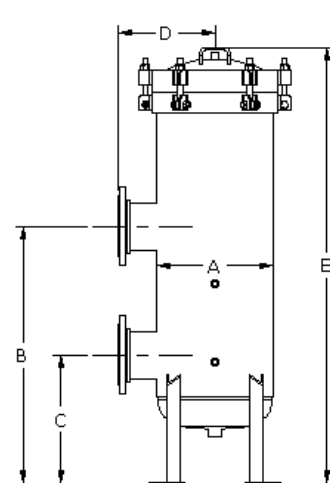

ISC Sales

ISCSales.com
ISCInfo@ISCSales.com

877-602-0010
972-964-2700

4421 Tradition Trail
Plano, TX 75093